

Building Sketch

Borrower	None - See Client Information			
Property Address	1193 Rowell Dr			
City	Lyons	County Larimer	State CO	Zip Code 80540-8333
Lender/Client	Laura Levy Group			

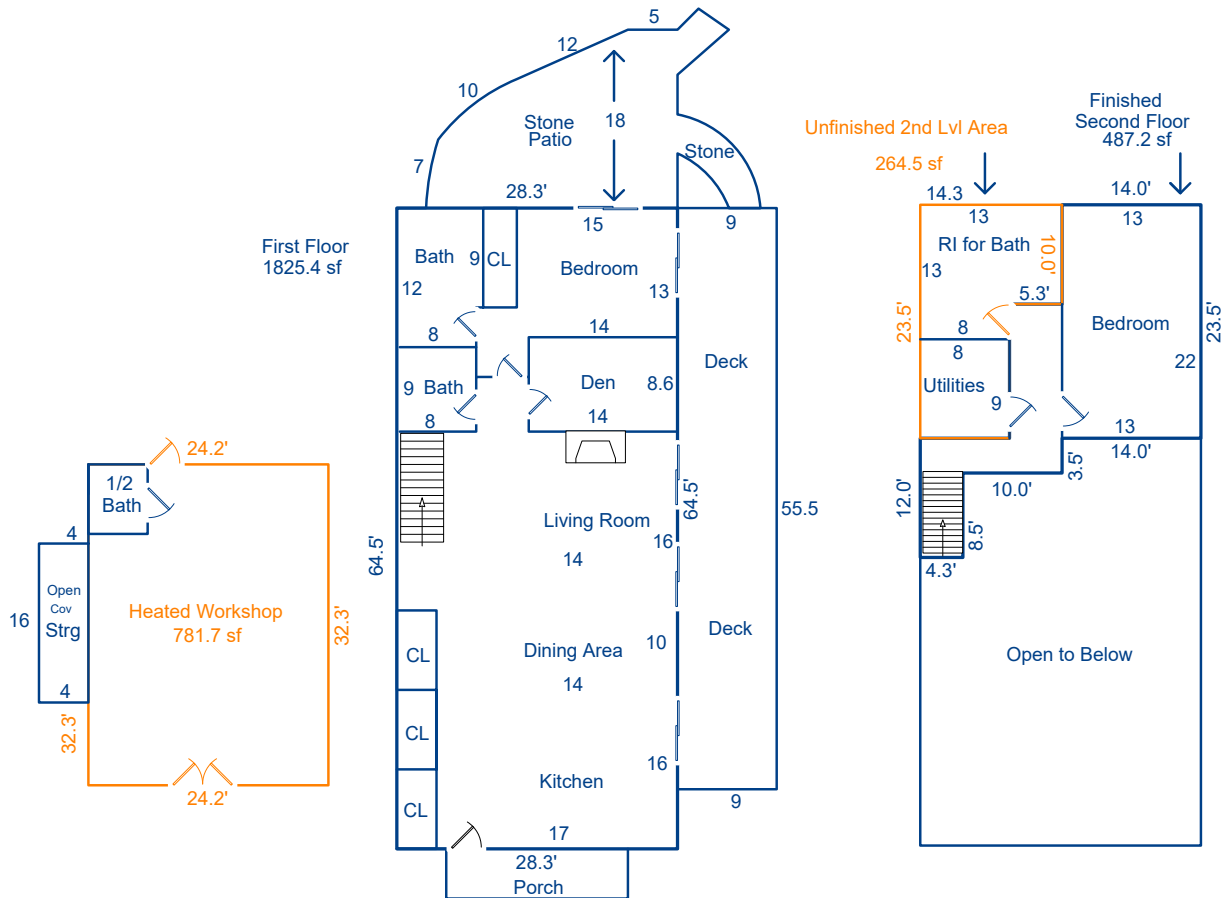

Sketch by ApexSketch

AREA CALCULATIONS SUMMARY						AREA CALCULATIONS BREAKDOWN				
Code	Description	Factor	Net Size	Perimeter	Net Totals	Name	Base x	Height x	Width =	Area
GLA1	First Floor	1.0	1825.4	185.6	1825.4	First Floor	64.5 x	28.3 =		1825.4
GLA2	Second Floor	1.0	487.2	127.6	487.2	Second Floor	12.0 x	4.3 =		51.6
OTH	Heated Worksho	1.0	781.7	113.0			10.0 x	3.5 =		35.0
	Unfinished 2nd L	1.0	264.5	75.6	1046.2		13.5 x	5.3 =		71.5
							23.5 x	14.0 =		329.0
	Net LIVABLE	cnt	2	(rounded)	2,313	5 total items			(rounded)	2,313

© ILOOKABOUT (US) Inc. dba Apex Software